



## DE WARANDE

Warandestraat 42  
2300 Turnhout • België

www.warande.be  
+32 14 41 94 94

## TECHNICAL RIDER KUUB DE WARANDE

**technical crew** Niels Decoster  
Peter Gevers  
Ferre Goeyvaerts  
Pieter Helsen  
Paul Kox  
Michel Proost

**pour toutes informations techniques ou pour un rendez-vous merci de nous contacter entre 9h et midi au** +32 14 47 21 24

**e-mail** theater@warande.be

**en cas d'absence** Bert Heylen (programmeur de dance et théâtre)  
bert.heylen@warande.be, +32 14 47 21 52

## TECHNICAL INFORMATION

<b>loading dock</b>	<b>at the back of de Warande (Wezenstraat)</b> width 2,7 m height 3,3 m rise from street to stage level 0,7 m	
<b>piano</b>	3/4 grand piano Steinway	1
<b>draperies / of</b>	legs 8,3 m x 2,74 m	8
<b>curtains</b>	drapery borders 3 m x 13,7 m	4
	back cloth in two parts 8,3 m x 6,94 m	1
	sky cloth 8,3 m x 13,7 m	1
	drapery borders proscenium opening scene 8 m x 13,70 m	1
<b>rostra legs</b>	2 m x 1 m	48
<b>pieds</b>	20 cm	48
	40 cm	72
	60 cm	72
	80 cm	96
	100 cm	24
	120 cm	176
<b>escaliers avec garde-fou</b>		2
<b>gardes-fou</b>	2 m	24
<b>jupes de scène</b>	2 m x 1,20 m	14
<b>black or grey dance floor</b>	15 m x 1,5 m	8
<b>scissors lift</b>	max height 7,6 m	1
<b>projecting material</b>	Eiki LC-X4L 5200 Ainsilumen	1
<b>intercom</b>	Clearcom mainstation	1
	headsets + beltpacks	5
<b>dressling room</b>	5 persons	2
<b>with shower</b>	10 persons	1
<b>green room</b>	sous-sol	
<b>auditorium capacity</b>	standing	780
	sitting	240

## SOUND

Front Of House	type	number
<b>In House PA System</b>	<b>theatre setup</b>	
	Martin Audio W8LM Line Array (4*W8LM+1*W8LMD/side)	
	Martin Audio WMX subs (1/side, flown with Line Array)	
	Crest (Pro200) and Powersoft (K-series) amps	
	XTA DP processors	
	<b>concert setup</b>	
	Martin Audio W8LM Line Array (4*W8LM+1*W8LMD/side)	
	Martin Audio WS218X subs(2/side) groundstacked in end-fire configuration	
	Crest (Pro200) and Powersoft (K-series) amps	
	XTA DP processors	
	<b>multi-cores</b>	
	splitrack 40in/8out	
LK150 to hall-floor and balcony		
LK150 break-out to XLR	2	
12ch stageboxes	5	
<b>FOH</b>	<b>set A (concert)</b>	
	Soundcraft MH3/40+4 + 2xPSU	
	2*31b KT GEQ on L/R	
	Lexicon PCM91	
	TC M3000	
	Yamaha SPX2000	
	TC D2	
	8ch comp/gate/limit DBX	
	4ch comp BSS	
	8ch gate Drawmer	
	Tascam CDRW900	
	<b>set B (theatre)</b>	
	Crest X4/8+4	
	MD Sony	
	CD Denon	
	<b>set C (digital)</b>	
	Yamaha O1V/96	
	MD Sony	
CD Denon		
<b>monitors</b>	Soundcraft MH3/40+4 (PRE fader = POST EQ)	
	Martin Audio LE1200	12
	Crest Pro7200 amps	6
	Meyer USW subs for drumfill	2
	Crest MA amp	1
	KT Square One 2*31b GEQ	5

**NOTE: This list contains material for the two venues, its best to check the availability of the microphones.**

<b>micro + DI set</b>	radial j48	2
	Active D.I.: LD102	6
	Active D.I.: BSS AR 133	2
	atm 350	5
	at 8015	2
	AT AE3000	4
	AKG 414 B-XL2 matched stereo couple	2
	AKG 451	1
	AKG D112	1
	Neumann km 184	4
	Neumann kms 105	1
	Sennheiser E904	3
	Sennheiser E906	2
	Sennheiser MD421	2
	Shure B52	1
	Shure B56	2
	Shure B57	2
	Shure B58	2
	Shure SM 57	6
	Shure SM 58	8
	Shure B 91	1
	PCC 160	2
	ae3000	4
	<b>Shure UHF:</b>	
	ur4d receiver [518 - 578 mhz]	1
	ur2 sm58 [518 - 578 mhz]	2

## LIGHTS

<b>light board</b>	ADB Mentor	240 circuits	1
	ADB Tenor	240 circuits	1
	Grand MA light + wing		1
	DMX 512 Booster	1 in > 8 out	1
	dimmers	24 X 5 KW	
		96 X 3 KW	
		48 X 3 KW	

<b>position</b>	<b>additional</b>	<b>type of Spots</b>	<b>number</b>
<b>lighting equipment</b>	houelights	ETC 750 W MCM	16
	PC 1 kw	ADB C101	26
	barndoors1 kw	CFN 185	22
	profile 1 KW	Robert Juliat 614 SX	12
	PC 2 kw (fixed position bridge)	ADB C201	12
	fresnel 2000 W	ADB F 201	12
	barndoors 2 kw	CFN/245	8
	profile 800 w	ADB Warp 15°-30°	8
	profile 800 w	ADB Warp 22°-50°	4
	profile 2 kw (fixed position bridge)	Robert Juliat 714 SX	8
	Cyclorama lighting RGB	ADB ACP 1003	5
	Cyclorama lighting (single)	ADB ACP 1001	4
	PAR 64 Thomas	CP 60	20
		CP 61	20
		CP 62	20
		floorlite CP 62	10
	LF 1000 W	ADB LF 1000	4
	six-bar	CP 61	2
		CP 62	4
	four-bar	CP 61	4
	moveble reel	11dimmerchannel + 1 x fixed power	8
	multi 20 m	20 m	2
	multi 15 m	15 m	6
	multi 10 m	10 m	6
	multi 5 m	5 m	6
	multi 3 m	3 m	6
	breakout	8 x CEE + harting in/out	12
breakout		8	
powerdrive stand	black max. height 3,8 m	6	

## FLY-PLOT

### description

total width = 17,5 m, total length = 29m

18 elektricale flybars maximum weight 400 kg each

distance between the flybars is 60 cm, length flybars 13,4 m, diameter 50 mm

elektrical moveble bridge and 3 moveble truss

### spare powerconnections backstage

#### transfo sound

1 x 63A 3P+ N + A 220/380 volt

1 x 32A 3P+ N + A 220/380 volt

4 x 20A 2P+ A 220 volt

### light

2 x 125A 3P+ N + A 220/380 volt

2 x 63A 3P+ N + A 220/380 volt

2 x 32A 3P+ N + A 220/380 volt

4 x 20A 2P+ A 220 volt

# GROUNDPLAN

Kuub

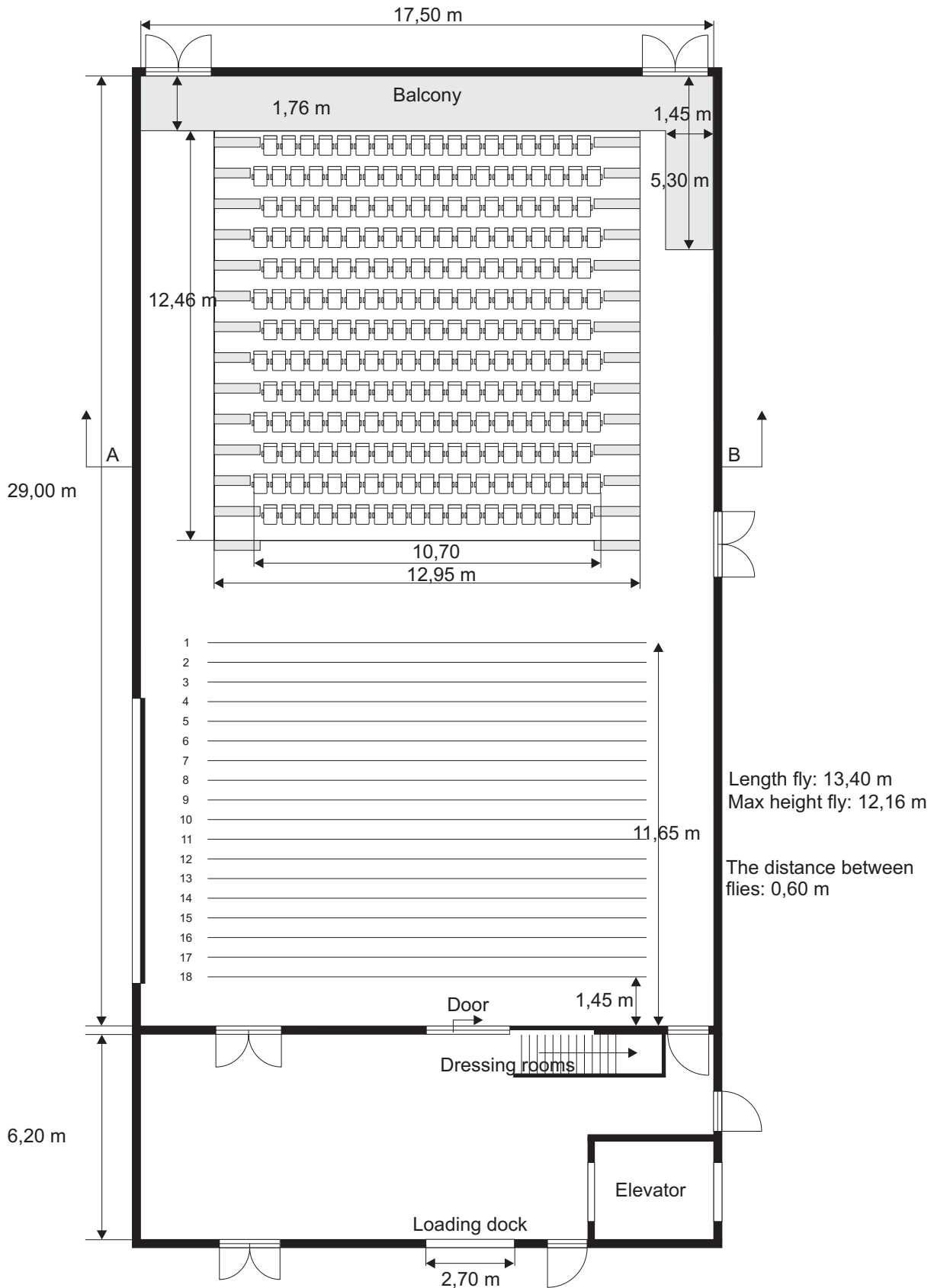

Kuub scale 1/100

5 m

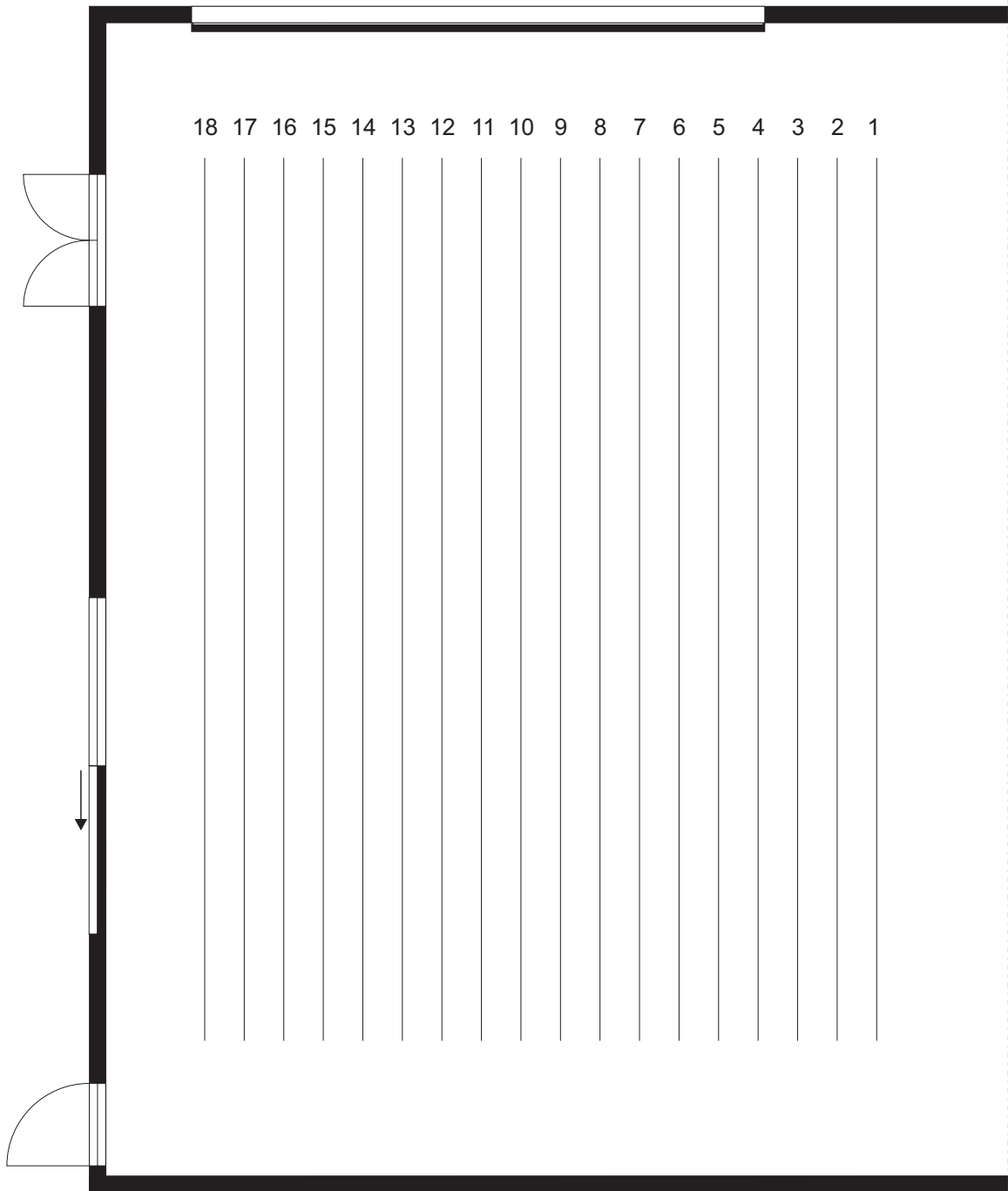
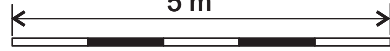



Kuub scale 1/100

5 m

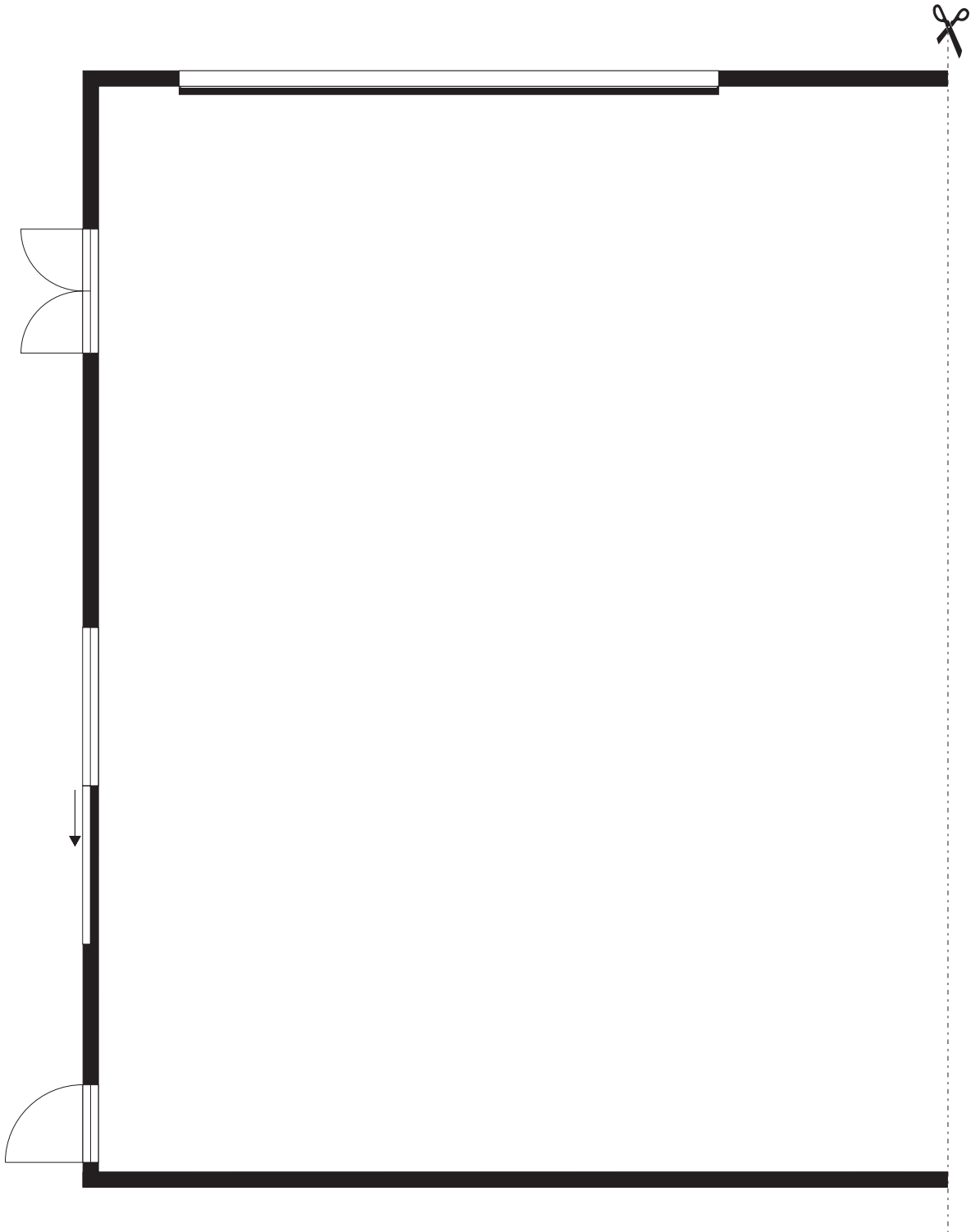
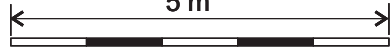

Kuub scale 1/100

5 m

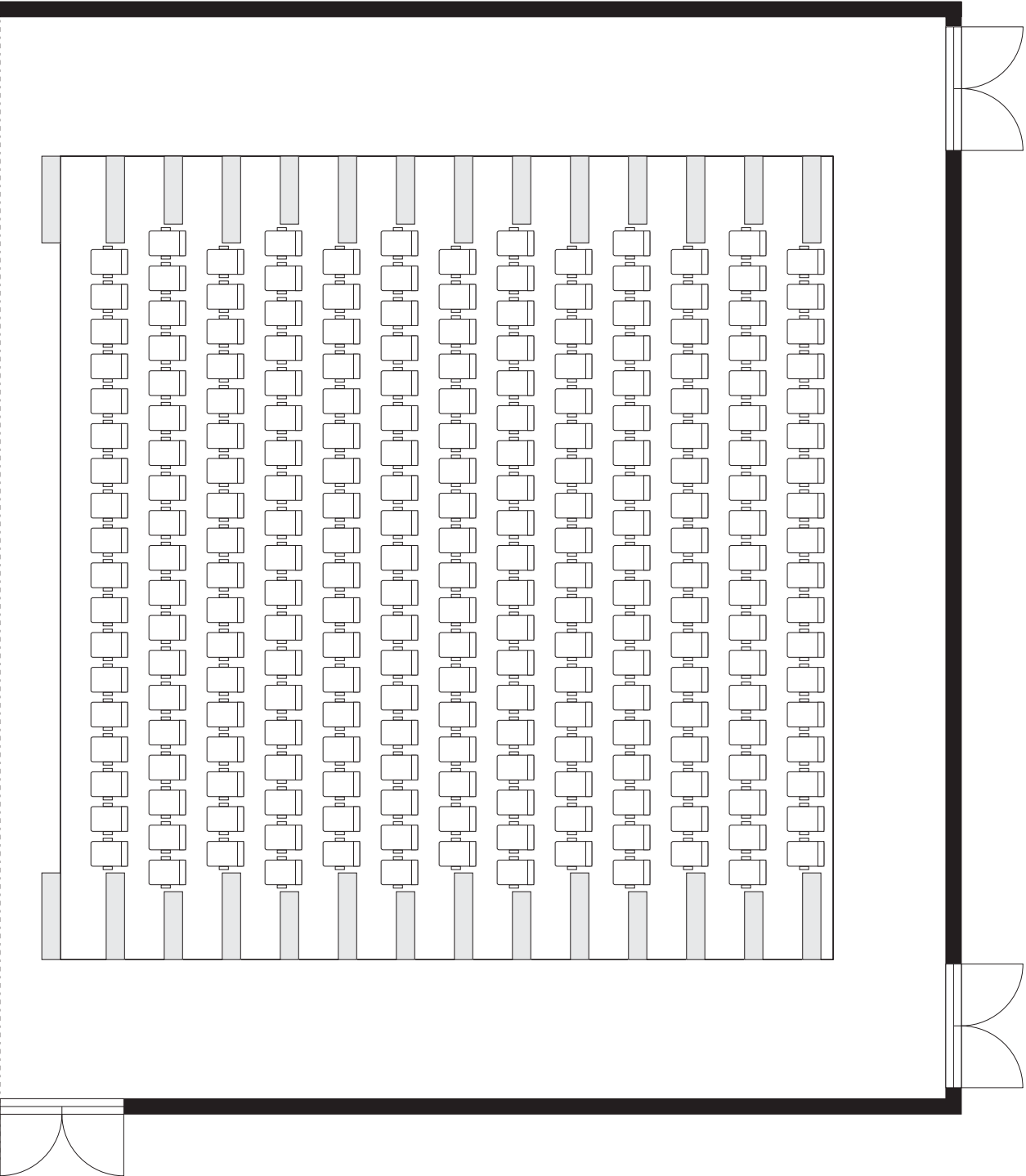
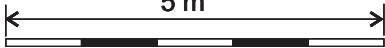

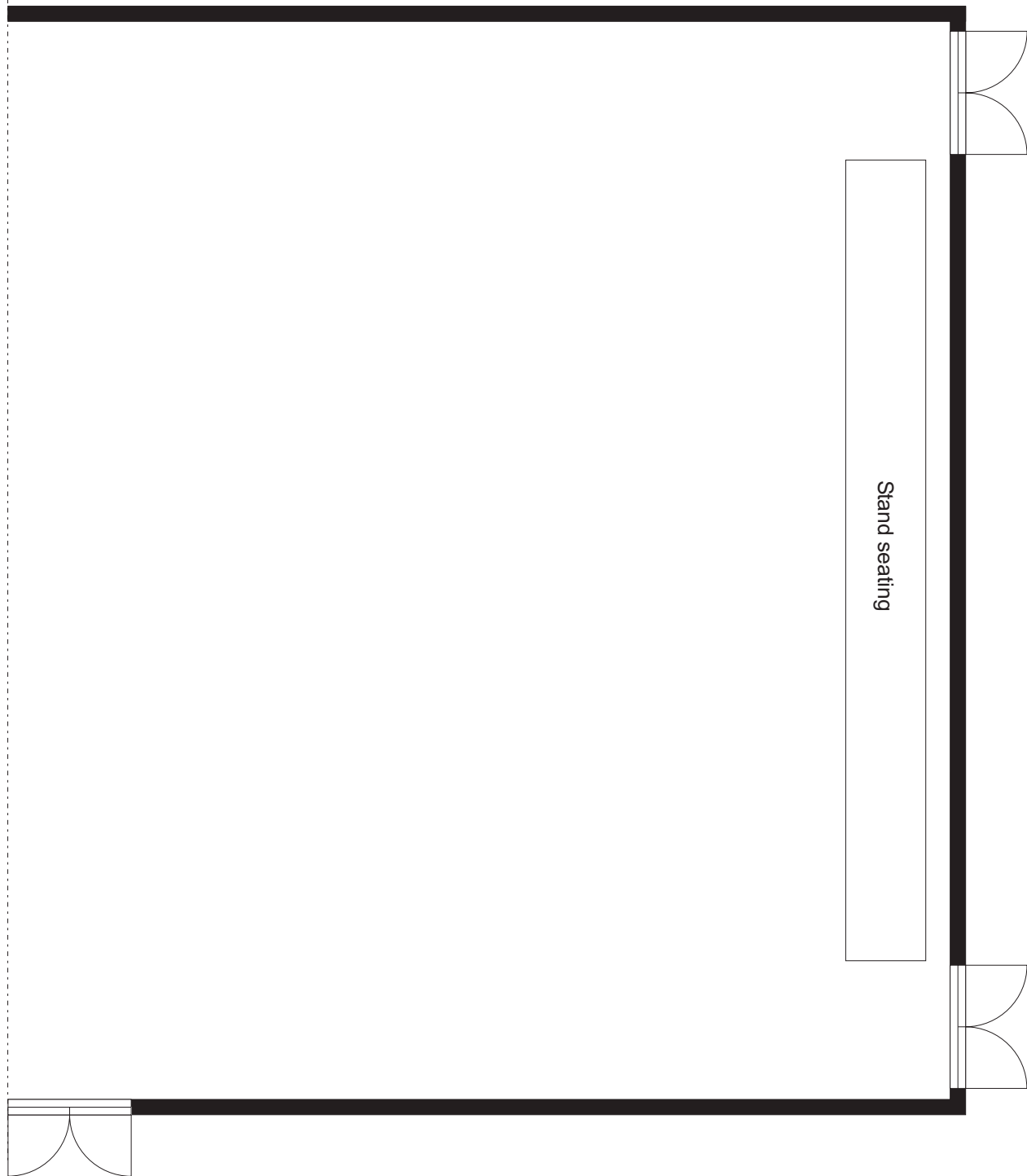

Sectional plan

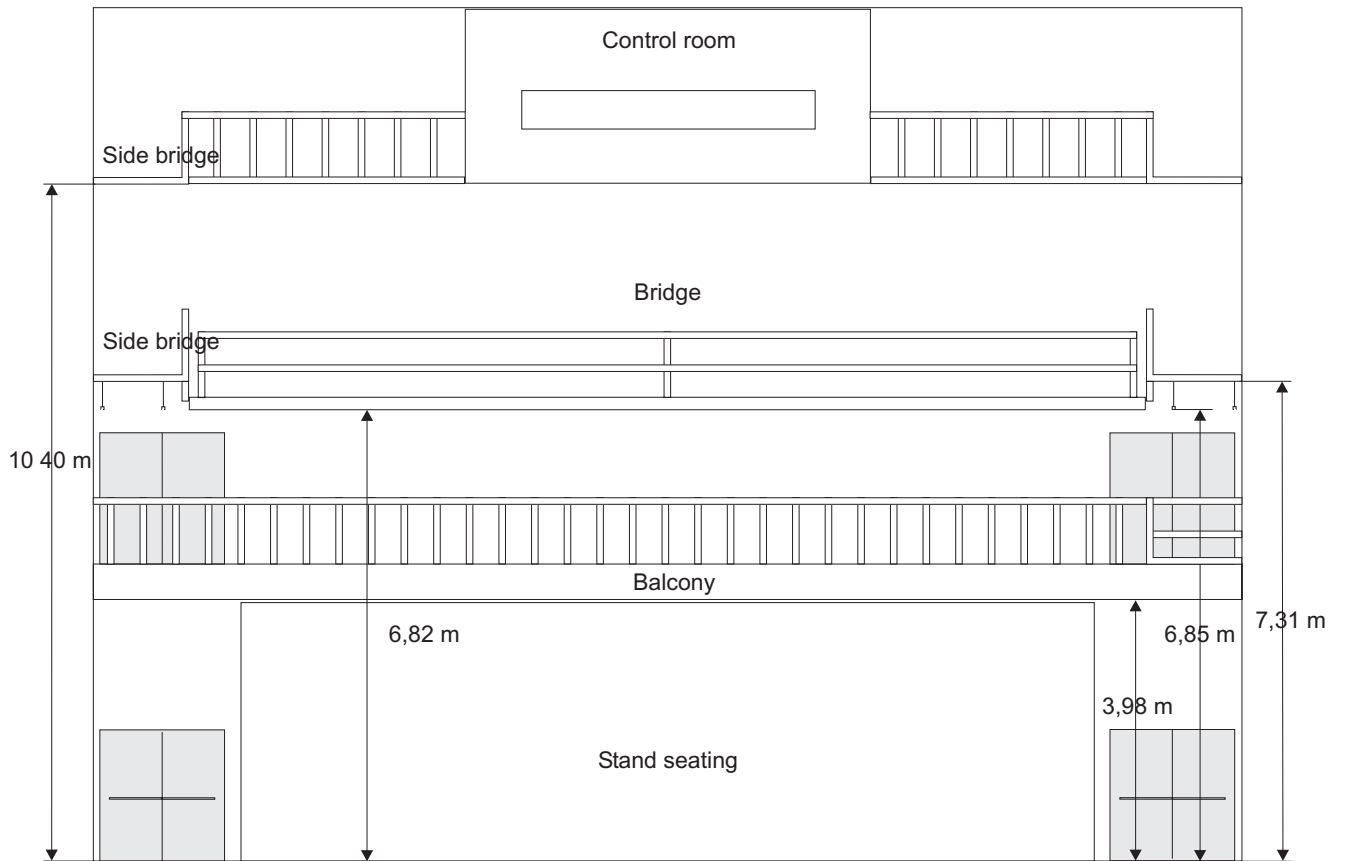

## LIST OF HOTELS

**Viane** Korte Vianenstraat 2  
2300 Turnhout  
tel. +32 14 41 47 48  
fax. +32 14 41 53 43  
www.corsendonkviane.be

**Tegenover** Stationsstraat 46  
2300 Turnhout  
tel. +32 14 43 47 05  
www.hoteltegenover.be

**Ter Driezen** Herentalsstraat 18  
2300 Turnhout  
tel. +32 14 41 87 57  
www.ter-driezen.be

**Best Western** Stationsstraat 5  
2300 Turnhout  
tel. +32 14 82 02 02  
www.turnhoutcity-hotel.be

## HOW TO GET THERE

